

# I.S. ZENER BARRIER 10-7072 Intrinsically Safe Zener Barrier



Document Date: 12/04/2024

Product Rev: 1

PIB No: 9M02-10-7072



[cattron.com/products/bwi-eagle](https://cattron.com/products/bwi-eagle)



655 N River Rd NW, Suite A  
Warren, OH 44483

724-283-4681  
[sales.bwieagle@cattron.com](mailto:sales.bwieagle@cattron.com)

## WARRANTY STATEMENT

Cattron warrants the Air-Eagle Remote Control System, if properly used and installed, will be free from defects in material and workmanship for a period of 1 year after date of purchase. Said warranty to include the repair or replacement of defective equipment. This warranty does not cover damage due to external causes, including accident, problems with electrical power, usage not in accordance with product instructions, misuse, neglect, alteration, repair, improper installation, or improper testing. This limited warranty, and any implied warranties that may exist under state law, apply only to the original purchaser of the equipment, and last only for as long as such purchaser continues to own the equipment. This warranty replaces all other warranties, express or implied including, but not limited to, the implied warranties or merchantability and fitness for a particular purpose. Cattron makes no express warranties beyond those stated here. Cattron disclaims without limitation, implied warranties of merchantability and fitness for a particular purpose. Some jurisdictions do not allow the exclusion of implied warranties so this limitation may not apply to you. To obtain warranty service, contact Cattron for a return material authorization. When returning equipment to Cattron, the customer assumes the risk of damage or loss during shipping and is responsible for the shipping costs incurred.

## SIGNAL RANGE

Max range statements are estimates based on a clear line of sight with few interferences. Actual range will vary based on transmitting power, orientation of transmitter and receiver, height of transmitting and receiving antennas, weather conditions, electronic interference, terrain, and physical obstacles, including but not limited to; walls, building structures, trees (foliage), metal objects, and landscape (hills, mountains).



## WIRELESS STOP, ASTOP, and E-STOP SYSTEMS

Wireless E-STOP systems should never be considered a primary life-saving device. At least one hard-wired switch must be available in the event the wireless system is not operational. Failure to comply may result in serious injury or death to personnel and damage to equipment.



Wireless STOP and ASTOP transmitters are not failsafe emergency stop controls. They are NOT to be used as a life-saving device. They are designed for wireless control of equipment or vehicle remote operation. Failure to use as intended may result in serious injury or death to personnel and damage to equipment.



SCAN ME



**APPROVALS**

MSHA	IA446-0
------	---------

**DIMENSIONS**

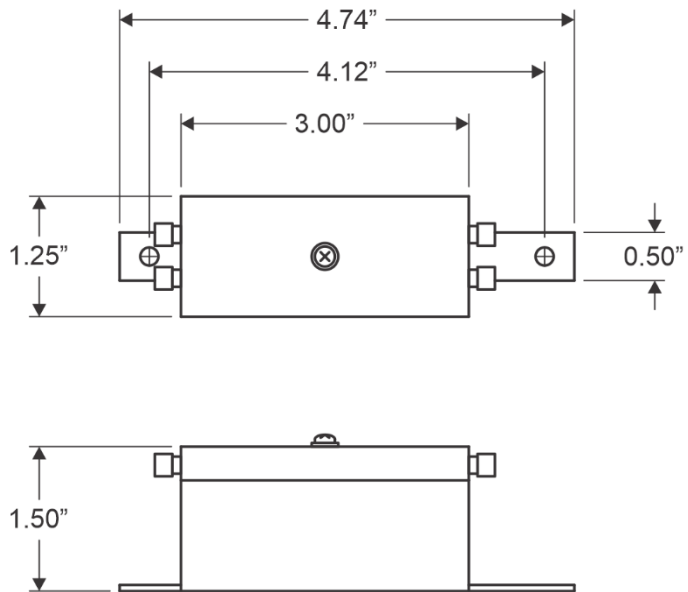

## INSTALLATION

When installing the Zener Barrier to the control unit, the polarity of the wiring from the control unit to the Zener barrier must be carefully observed.

Terminal	Wiring
1	Input from control unit (+) positive
2	Output to I.S. Sensor (no polarity)
3	Input from control unit (-) common
4	Output to I.S. Sensor (no polarity)

